

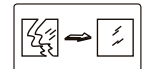

Distance between screw holes (D). Mounting screws not included.



Tc max=105°C
Risk group(EN 62471:2008)=1



 Fitting must only be used complete with their protection cover. Tempered safety glass or polycarbonate cover of dimensions 177x177 mm and 5 mm thickness.

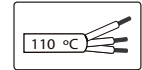

Installation cable must support 110°C temperature. Feeding cable must be cable pipe 3x1 mm². Installation may require advice.

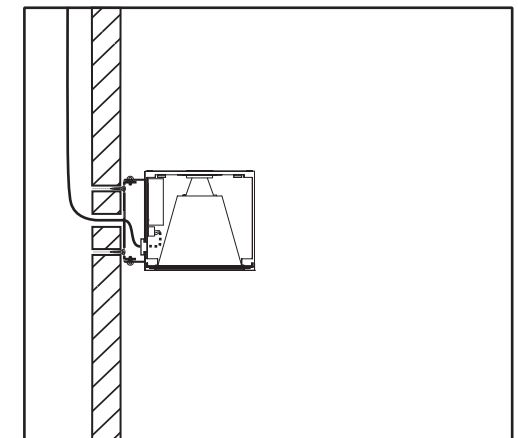
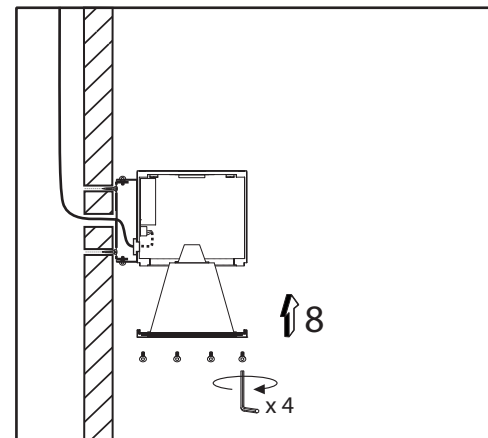
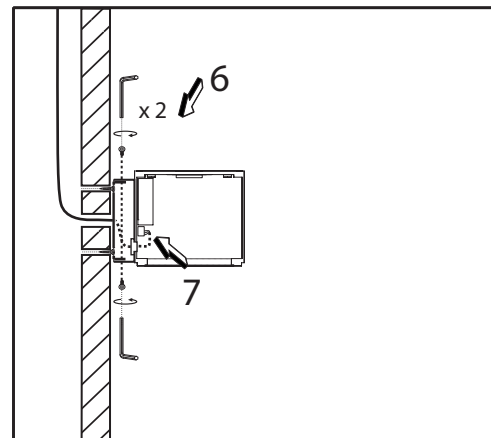
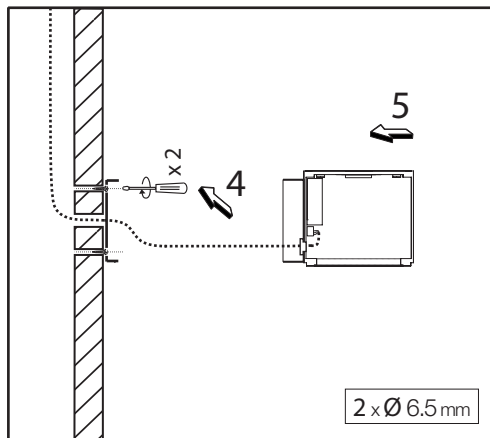

Do not accumulate excess of cable into the fixture.

 6.15Kg

This product contains a light source of energy efficiency class D.

General safety instructions: information on restrictions related to use of the light fixtures (class, IP, etc), can be found both on the fixture label and on our website at www.rovasi.com.

The wiring schematics can be found on page 2 of the document.

ELECTRONIC EQUIPMENT:

S: On/Off .

D: DALI/DSI/switchDIM. There are accessories available for dimming devices.

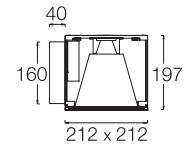

18.33W / 500mA

101TMS.1.01-l869
101TMS.1.01-l870
101TMS.1.01-l871

WIRING GUIDELINES

Installation instructions. Mains supply wires

- Wiring type and cross section
- Solid wire a cross section of 0.5 -2.5mm² . Strip 10-11 mm of insulation from the cables to ensure perfect operation of terminals.
- Use one wire for each terminal connector only.
- Use each strain relief channel for one cable only.
- Installation may require advice from a qualified person.
- Single lights apt for outer use.

Wiring guidelines

- All connections must be kept as short as possible to ensure good EMI behaviour.
- The cables should be run separately from the mains connections and mains cables to ensure good EMC conditions.
- The LED wiring should be kept as short as possible to ensure good EMC.
- The max. secondary cable length is 2m (4m circuit). Secondary switching is not permitted.
- Incorrect wiring can damage LED modules.
- The LED Driver has no inverse-polarity protection on the secondary side. Wrong polarity can damage led modules with no inverse-polarity protection.

- Earth connection is recommended to improve following behaviour.
- Electromagnetic interferences (EMI)
- Transmission of mains transients to the LED output.



Release of the wiring
Press down the "push button"
and remove the cable from front

Circuit diagram S:Electronic constant current drivers

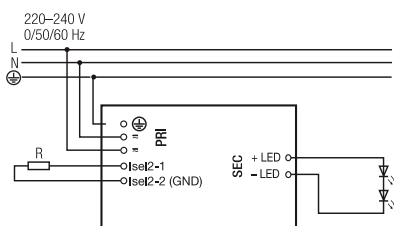

Circuit diagram A: ** 1-10V [to consult]

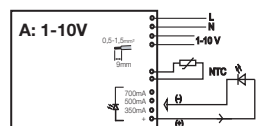

Circuit diagram A: ** 1-10V [to consult]
[class I]

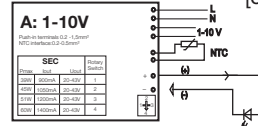

Circuit diagram P: Phase cut[®]

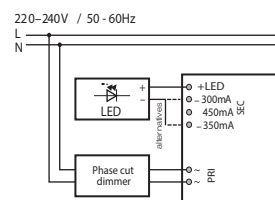

Input terminal (D2) 0.5 - 2.5mm²
max. Ø = 8.0 mm
min. Ø = 4.0 mm

Output terminal (D1) 0.5 - 2.5mm²
max. Ø = 6.0 mm
min. Ø = 2.0 mm

Only available for following
power:
12W / 17W / 23W / 36W.

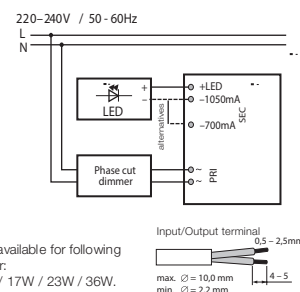

Circuit diagram D: DALI/DSI/SwitchDIM/corridorFUNCTION

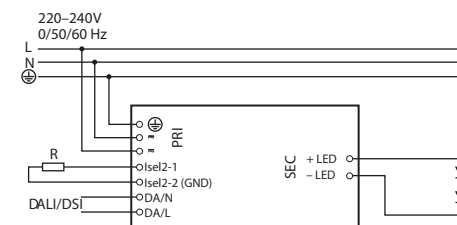

UPGRADEABLE, REPLACEABLE, REPAIRABLE

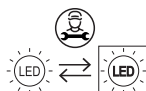

The servicing of the light source in this luminaire should only be undertaken by the manufacturer or his service agent or a similar qualified person.

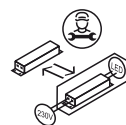

The servicing of the driver in this luminaire should only be undertaken by the manufacturer or his service agent or a similar qualified person.

1

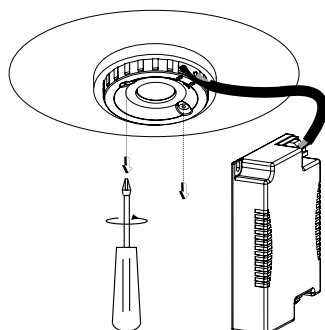

2

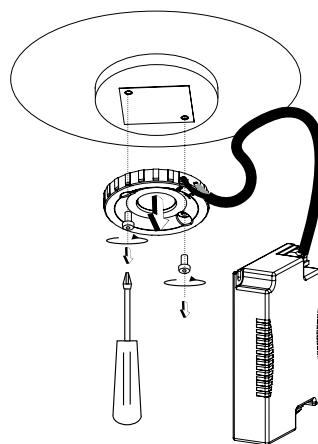

3

