

Recommended accessory IP68 junction box F3.A3 or F3.A5

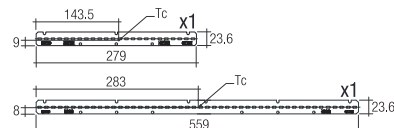

Tc max=85°C Risk group(EN 62471:2008)=1

 Fitting must only be used complete with their protection cover. Tempered safety glass or polycarbonate cover of dimensions 561x52,5 mm and 4 mm thickness.

 Installation cable must support 110°C temperature. Feeding cable must be cable pipe 3x1 mm². Installation may require advice.

 Attention: We do recommend being installed by two people for proper safety.



General safety instructions: information on restrictions related to use of the light fixtures (class, IP, etc), can be found both on the fixture label and on our website at www.rovasi.com.

The wiring schematics can be found on page 2 of the document.

ELECTRONIC EQUIPMENT:

S: On/Off.

D: DALI/DSI/switchDIM.

A: 1-10V. There are accessories available for dimming devices.

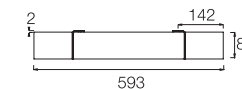

7.1W / 150mA

671DST.4.01-I723
671DST.4.01-I724
671DST.4.01-I725
671DST.4.01-I726

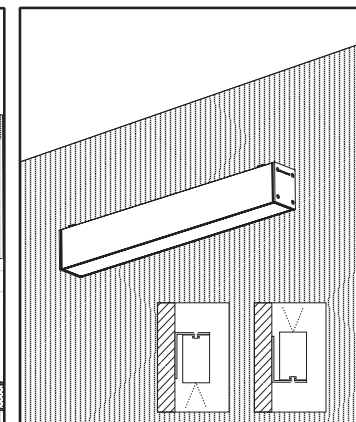
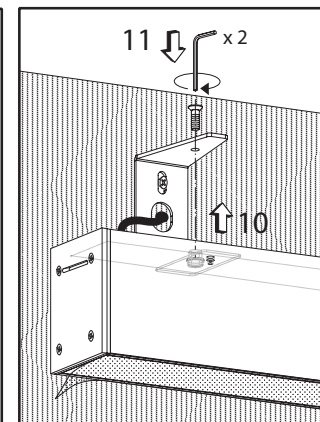
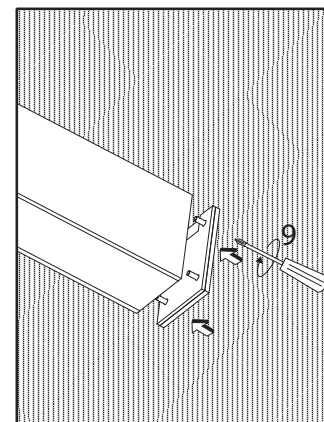
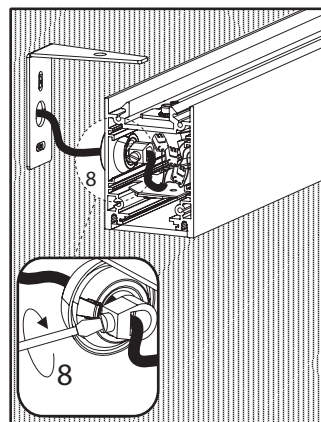
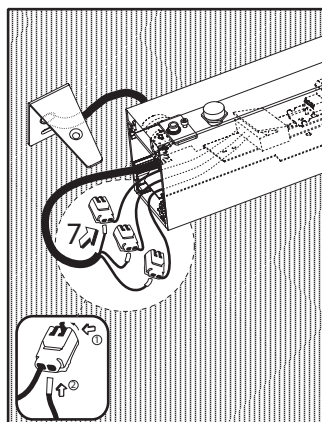
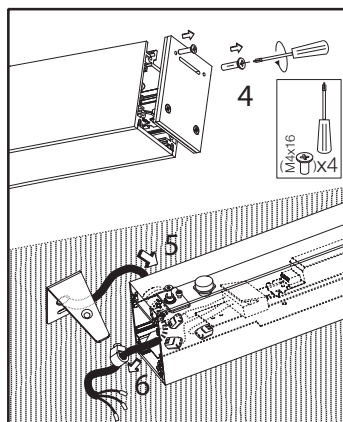

This product contains a light source of energy efficiency class D.

LED technology and performance data are constantly changing. Current details should therefore be checked with ROVASI in order to ensure that its still the mostup to date reference. Updated data will be supplied on request. [08.08.2023]

- Wiring type and cross section
- Solid wire with a cross section of 0.5 – 1.5 mm².
- Strip 8-9mm of insulation from the cables to ensure perfect operation of the push terminals.
- Use one wire for each terminal connector only.
- Use each strain relief channel for one cable only.
- Installation may require advice from a qualified person.
- Single lights apt for outer use.

- All connections must be kept as short as possible to ensure good EMI behaviour.
- Earthing is not required for the device to operate but will improve the EMI behaviour.
- The max. secondary cable length is 2m (4m circuit).
- Secondary switching is not permitted.
- Incorrect wiring can damage LED modules.

o Note: The length of LED module must not be exceeded. Note that the length of the EM converter LED leads to the LED module will be added to the length of the leads from the control gear to the EM converter LED module when considering the lead length of the control gear. Leads should always be kept as short as possible.

The LED terminals, battery, indicator LED and test switch terminals are classified as SELV (output voltage <60V DC). Keep the wiring of the input terminals separated from the wiring of the SELV equivalent terminals or consider special wiring (double insulation, 6mm creepage and clearance) when these connections should be kept SELV.

EM: Electromagnetic
EMC: Electromagnetic Compatibility
DC: Direct current
SELV: Safety extra low voltage

Switched Line out

Switched Line in

Neutral

Un-Switched Line

Lout

Lin

N

L

EM Converter LED BASIC

Control gear

LED

LED

LED

Control gear

Battery

Battery

Test switch Indicator or LED

P

O

Neutral

PRI

I sel 2:1

I sel 2:2 (GND)

DAI/N

DAI/L

D: DALI/DSI

SEC

+ LED

- LED

D: Switch corridor

N

L

switchDM 220-240 V 50/60 Hz

Switched Line out
Switched Line in

Neutral
DALI
DALI
Un-Switched Line

Lout
Lin
N
DALI
DALI
L

EM Converter LED PRO

Control gear
LED
LED
Control gear
Battery
Battery

Test switch
Indicator or LED

P
O

SEC + LED
SEC - LED

D: DALI/DSI

D: SwitchDIM/
corridorFUNCTION

switchDIM
220-240 V
50/60 Hz